

## Main Components

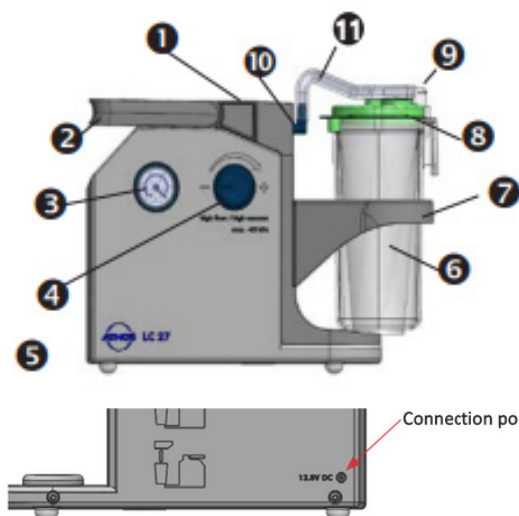

1. Control panel
2. Carrying handle
3. Vacuum Gauge
4. Vacuum adjustment (from - to +)
5. Connection for the mains power unit
6. Serres outer cannister
7. Support for Serres outer canister
8. Serres suction liner
9. Angle (connection for the disposable suction hose)
10. DDS bacterial and viral filter cartridge for disposable system
11. Vacuum hose

Connection point for the **Atmos** charger plug

## Connecting the Liner

**Step 1:** Press the big blue button at the top of the cannister to expose the filter. Ensure the blue connection for the vacuum hose must point towards 12 o'clock.

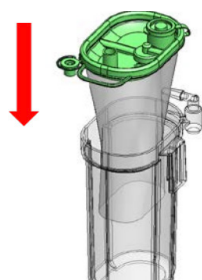
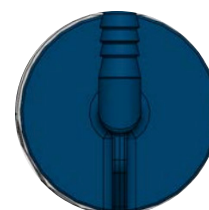

**Step 2:** Place the Serres® cannister (the outer container with the liner inside) into its holder. Make sure the measurement scale on the cannister is facing towards the machine.

**Step 3:** Connect the vacuum hose to the DDS filter, then attach the other end to the angled connector on the Serres® cannister. Put the cannister in the holder.

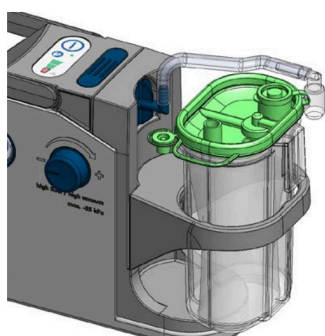
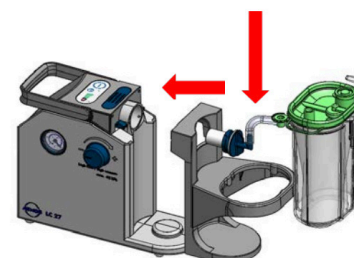

**Step 4:** Connect the disposable suction tube to the Serres® suction liner. On the suction fingertip, cover the small hole on the side with your thumb. This hole controls the suction: leaving it open gives gentle suction, covering it makes the suction stronger. At the same time, cover the front opening of the fingertip with your thumb.

## Pre-checks before starting a clinic

**Plug in Charger:** Ensure the machine is plugged in for maximum suction power.

**Set Pressure to Max:** Rotate the blue dial clockwise to full towards the '+'.  

**Attach the hose:** Connect the suction hose to the adapter on top of the liner bag.

**Turn On Unit:** Switch on the suction machine.

**Finger Over Suction Unit:** Place your finger over the end of the suction hose. You should feel the suction and see the gauge move higher.

## During appointment

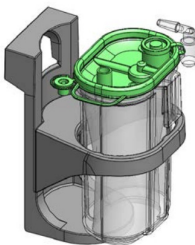

- **Monitor Liner Level:** Do not let the liner overfill to avoid damaging the unit.
- **Clean Suction Hose:** Sip a small amount of water through the hose between patients. Use fresh water for each patient.
- **Troubleshooting:** Stop and troubleshoot if the suction unit fails during an appointment. During the clinic

## Maintenance

- **DDS filter:** Replace the DDS bacterial and viral filter cartridge for disposable system after four months. (For removal wear gloves and rotate the filter anti-clockwise)
- **Suction hose:** Should be replaced at the very least every 2 months.





## Post appointment

**Step 1:** Take off the disposable suction hose and seal the patient connection on the Serres® suction liner with the green cap.

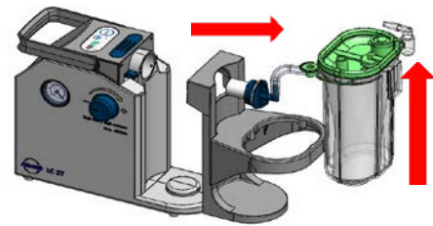

**Step 2:** Remove the vacuum hose and take the Serres® secretion canister system off its support. Take out the sealed suction liner from the outer canister.

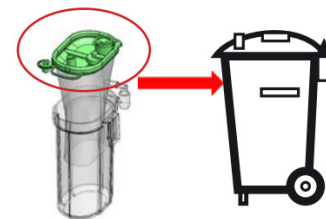

**Step 3:** Throw the sealed suction liner away



**Step 4:** Rinse the outer canister thoroughly under running water to clear residual liquids. Replace the liner.



## Troubleshooting

Problem	Cause	Solution
Low suction pressure	<ul style="list-style-type: none"><li>Bacterial filter is clogged</li><li>Hose is kinked</li></ul>	<ul style="list-style-type: none"><li>Replace the bacterial filter cartridge</li><li>Replace the suction hose</li></ul>
Device cannot be recharged	<ul style="list-style-type: none"><li>The mains power unit plug is not plugged in properly</li></ul>	<ul style="list-style-type: none"><li>Check the connection to the mains supply</li></ul>
Other suction unit issues	<ul style="list-style-type: none"><li>Email: <a href="mailto:support@tympahealth.com">support@tympahealth.com</a></li><li>Telephone: 08083048800</li></ul>	